



# iGATE EW12C/CG

## 802.11 AC WAVE 2 INDOOR MESH ACCESS POINT

**iGate EW12C/CG** is a Wi-Fi Access Point that creates a wireless local area network (WLAN) to share high-speed internet connection for user devices.

**iGate EW12C/CG** uses advanced Wi-Fi technology standard 802.11 ac wave 2, works simultaneously on 2 bands of 2.4GHz and 5GHz, capable of connecting multiple devices together to establish a uniform Wi-Fi Mesh network with only an SSID.

**iGate EW12C/CG** can perform as a Wi-Fi Router providing Wi-Fi connection, Wan Service via Ethernet connection or Wi-Fi repeater (receive Wi-Fi signal from other Access Points and sharing this for connected users). Especially with the Mesh function, the device easily setup to expand Wi-Fi coverage, provide a seamless, high-speed connectivity. **iGate EW12C/CG** is a powerful Mesh solution that provides perfect Wi-Fi coverage in every corner of your home, store, office.



## PRODUCT HIGHLIGHTS



### High reliability

Stable Operation  
High Throughput  
High Transmit Power

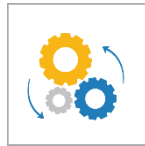

### Easy Management

WebGUI/CLI  
One Link (mobile app)  
One Mesh (Cloud)



### Global Standards

IEEE 802.11b/g/n@2.4G  
IEEE 802.11 a/n/ac@5G  
IEEE 802.11k,v



### Flexible Configuration

Remote config  
Local config  
Simple Expand



### Multi-WAN

Wireless  
Ethernet  
Repeater



### Mesh Radio

Single SSID  
Seamless Wi-Fi  
Adaptive path selection

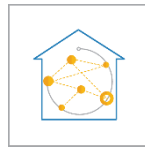

### 3D Antenna

Vertical &  
Horizontal  
Penetrating



### Seamless Roaming

Seamless connectivity  
(One SSID)



### High Performance

1.2 Gbps BW  
(Dual Band)



### Home Wi-Fi

User Access Control

## TYPICAL DEPLOYMENT MODELS

### Deploy Multiple APs as Mesh network

An iGate EW12C/CG connect to a Internet Gateway (ONT, Router) via Ethernet or Wi-Fi Repeater. Other iGate EW12C/CG connect with each other via Wi-Fi to setup Mesh Network. All iGate EW12C/CG can be remote management via apps or Cloud.

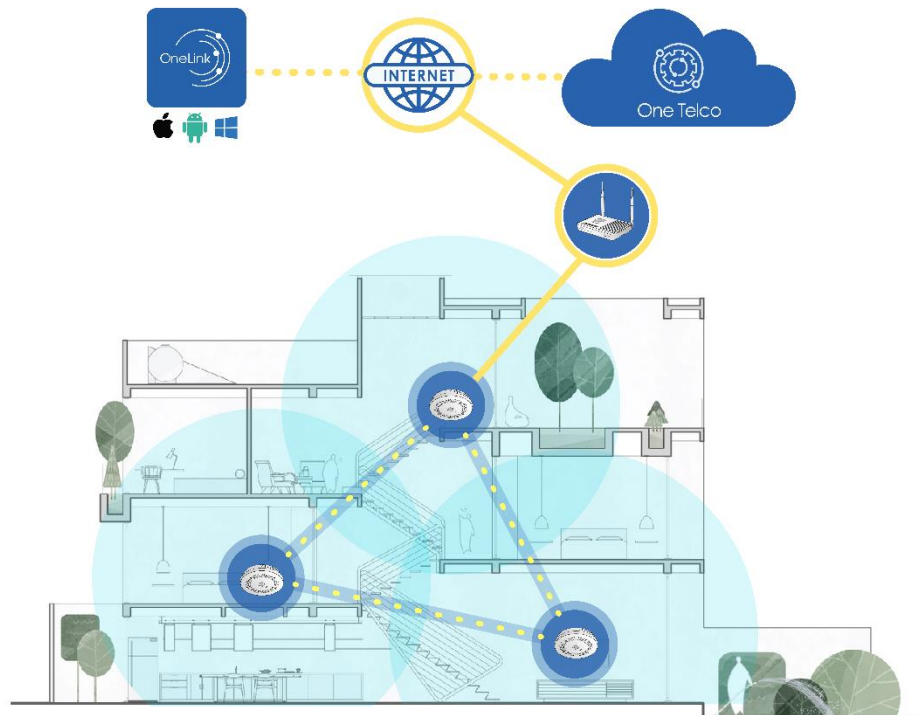

## FEATURES

### Wireless Features

- Operating Mode: AP, Repeater, Mesh (MRE-CAP)
- Active Dual Band: 2.4 GHz & 5 GHz
- Band Steering
- Limited Concurrent Client (CCU)
- Mesh Wi-Fi:
  - Auto Discovery & Configuration
  - Adaptive Path Selection
  - Load Balancing

- Seamless Roaming

### Security

- WPA-PSK, WPA2-PSK, WPA-EAP & WPA2-EAP
- WEP, TKIP & AES Encryption
- MAC Filtering
- SSID Hidden

### Home Wi-Fi

- URL Filtering
- Time Restriction

- LED Control (ON/OFF, Schedule)
- Group Access Management

## Protocols

- Management: HTTP,TR-069

## Network

- Forward & Routing Traffic: Bridging/ routing/ Static routing
- DHCPv4/DHCPv6 (Server, Client)
- PPPoE Client
- VPN Passthrough (IPSEC, L2TP, ...)
- VLAN
- IPv4/IPv6 Dual Stack, IPv6 only
- NAT
- Port Forwarding
- DNS/DDNS

## TECHNICAL SPECIFICATIONS

### Interfaces

- WAN 1x 10/100 Base -T Ethernet Port (iGate EW12C)
- 1x 10/100/1000 Base -T Ethernet Port, PoE support (iGate EW12CG)

## Management

- Local Management with WebGUI/CLI/Telnet
- Remote Management with Mobile App/Cloud (One Link/One Mesh)
- Device Information, Connection Statistic, Station monitoring
- Diagnostics Tool: Ping, Trace, Log
- Upgrade FW: Local, Remote
- Backup, Restore Configuration

## Multi-WAN

- Wireless WAN connectivity (support Dual Band 2.4GHz & 5GHz)
- Ethernet WAN Connectivity
- WAN Connectivity using Repeater from available SSIDs

### Wi-Fi

- IEEE Standards 802.11 a/b/g/n/ac wave 2
- PHY Rate 802.11v 2.4GHz: 300Mbps 5GHz: 867Mbps
- Channel 2.4GHz: 20/40 MHz

- Bandwidth 5GHz: 20/40/80 MHz
- Frequency 2.4 - 2.4835 GHz  
5.170 - 5.835 GHz
- Radios Dual Radio  
2.4GHz: MIMO 2x2:2  
5GHz: MIMO 2x2:2
- Antenna Internal Omni 2x2, 3dBi  
(2.4 GHz & 5 GHz)  
MU-MIMO, Beamforming
- EIRP 23dBm (iGate EW12C)  
26dBm (iGate EW12CG)
- SSID 4 SSIDs (2 SSIDs/radio)
- CCU 40 Users/Radio

## LEDs and Buttons

- Buttons 1x Power Button  
(Optional)  
1x Reset Button  
1x WPS Button

- LED 1x Power/WAN/Wi-Fi LED

## Power

- Types DC 12V-1A  
(iGate EW12C)  
PoE 802.3at/af,  
48V-1A (iGate EW12CG)
- Power 8W (MAX)  
Consumption

## Others

- Operating 0°C ÷ 50°C  
temperature
- Operating ≤95%  
humidity
- Mounting Wall/Celling
- Dimension  $\phi$ 164.7x43.6 mm

## iGATE EW12C/CG MANAGEMENT SYSTEM – ONE TELCO PLATFORM

- Support management:
  - Different types of equipment
  - Different protocol: TR-069, SNMP, CAPWAP...
  - Devices of multiple services: Internet, IPTV, voice...
  - Compatible with iGate EW12C/CG to form a complete Indoor Mesh Access Point solution:
    - Web Service: One Mesh Cloud Controller
    - Management Protocol: TR-069
- Optimal investment costs:
  - CAPEX: Data Center, Server, etc.
  - OPEX: Operating, Maintenance, etc.
- Main Features:
  - Devices Management: list devices, Group devices
  - Configuration Management: Remote Config/Command, Firmware Update, Configuration Backup/Restore
  - Report Management: Collect, Analysis, Alarm
  - Performance Management: Collect, Performance Statistics
- Advantages:
  - “Zero Touch” - automatic device configuration

- Import Data Model via file
- Build Data Model via interactive information from the device
- Micro Service Architecture, easy to extend new protocol & devices
- Flexible Deployment: hosted or on premise
  - Easy Scalability
  - Distributed deployment
  - Deployment on Cloud, Virtualization
  - Vertical & Horizontal scaling
- Open interface via REST API, JSON
- Advanced feature: QoS/QoE
- Easy to customize and integrate according to customer requirements



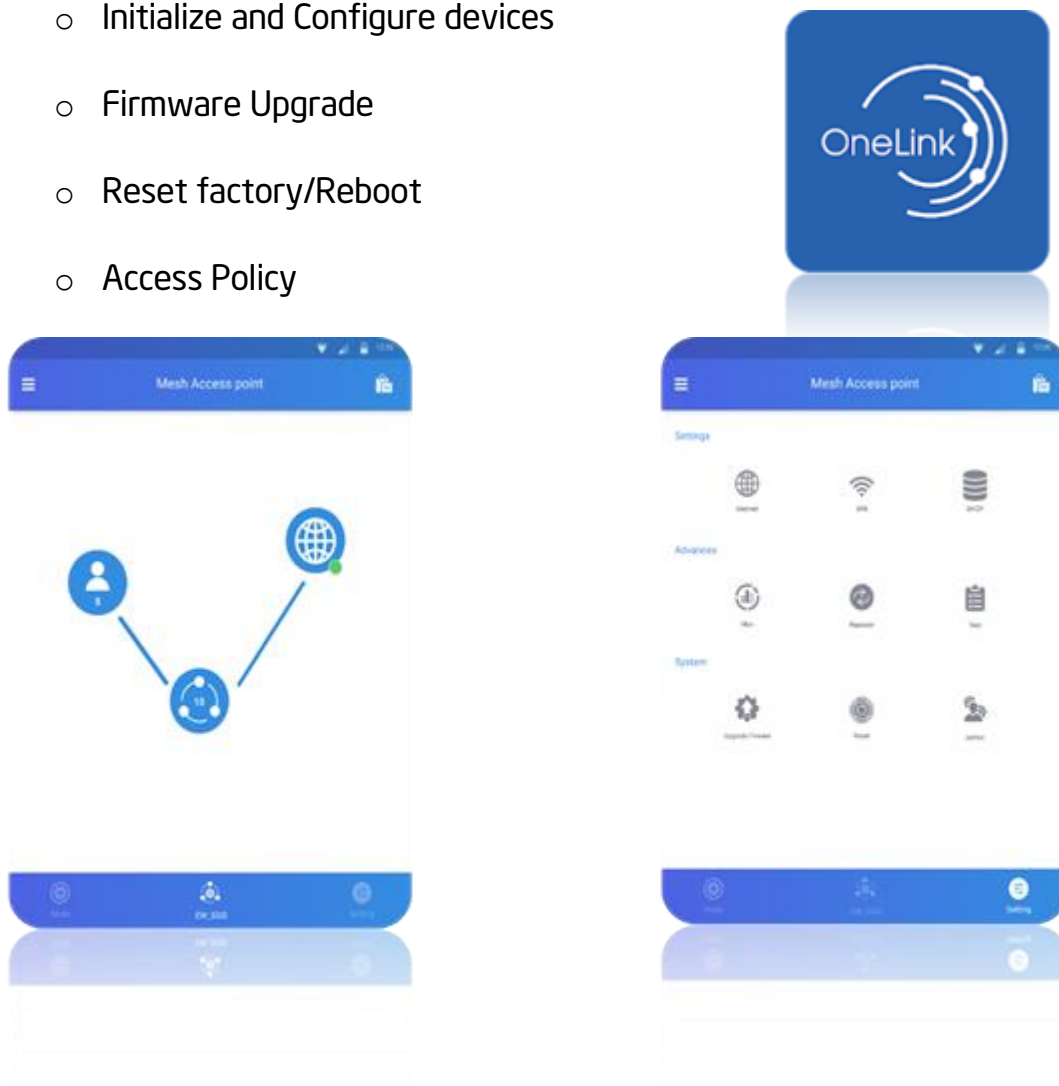

## iGATE EW12C/CG MOBILE APP – ONE LINK

- Support Management:
  - Remote Management via internet (integrate with ONE Telco Platform)
  - Local Management via iGate EW12C/CG's Wi-Fi
- Main Features:
  - Automatically connect to the network and search for iGate EW12C/CG
  - Device Status Management, Network Quality, User Information
  - Initialize and Configure devices
  - Firmware Upgrade
  - Reset factory/Reboot
  - Access Policy





## CUSTOMER CARE & TECHNICAL SUPPORT CENTRE

-  **Address:** 1st floor, VNPT Technology Building, No. 124, Hoang Quoc Viet Str., Cau Giay Dist., Hanoi, Vietnam
-  **Telephone:** +84.24.3750.6666 (24/7)
-  **Email:** support@vnpt-technology.vn