

iGATE EW12S/SG

802.11 AC WAVE 2 INDOOR MESH ACCESS POINT

iGate EW12S/SG is a Wi-Fi Access Point that creates a wireless local area network (WLAN) to share high-speed internet connection for user devices.

iGate EW12S/SG uses advanced Wi-Fi technology standard 802.11 ac wave 2, works simultaneously on 2 bands of 2.4GHz and 5GHz, capable of connecting multiple devices together to establish a uniform Wi-Fi Mesh network with only an SSID.

iGate EW12S/SG can perform as a Wi-Fi Router providing Wi-Fi connection, Wan Service via Ethernet connection or Wi-Fi repeater (receive Wi-Fi signal from other Access Points and sharing this for connected users). Especially with the Mesh function, the device easily setup to expand Wi-Fi coverage, provide a seamless, high-speed connectivity. **iGate EW12S/SG** is a powerful Mesh solution that provides perfect Wi-Fi coverage in every corner of your home, store, office.



PRODUCT HIGHLIGHTS



High reliability

Stable Operation
High Throughput
High Transmit Power

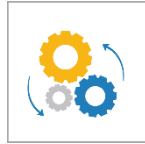

Easy Management

WebGUI/CLI
One Link (mobile app)
One Mesh (Cloud)



Global Standards

IEEE 802.11b/g/n@2.4G
IEEE 802.11 a/n/ac@5G
IEEE 802.11k,v



Flexible Configuration

Remote config
Local config
Simple Expand



Multi-WAN

Wireless
Ethernet
Repeater



Mesh Radio

Single SSID
Seamless Wi-Fi
Adaptive path selection



3D Antenna

Vertical &
Horizontal
Penetrating



Seamless Roaming

Seamless connectivity
(One SSID)



High Performance

1.2 Gbps BW
(Dual Band)



Home Wi-Fi

User Access Control

TYPICAL DEPLOYMENT MODELS

Deploy Multiple APs as Mesh network

An iGate EW12S/SG connect to a Internet Gateway (ONT, Router) via Ethernet or Wi-Fi Repeater. Other iGate EW12S/SG connect with each other via Wi-Fi to setup Mesh Network. All iGate EW12S/SG can be remote management via apps or Cloud.

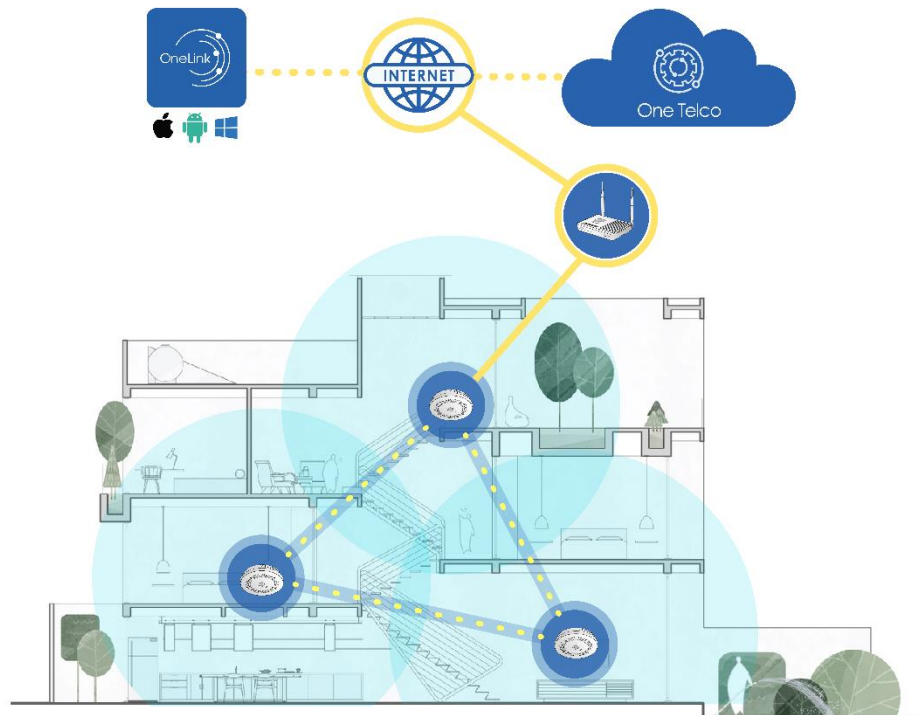

FEATURES

Wireless Features

- Operating Mode: AP, Repeater, Mesh (MRE-CAP)
- Active Dual Band: 2.4 GHz & 5 GHz
- Band Steering
- Limited Concurrent Client (CCU)
- Mesh Wi-Fi:
 - Auto Discovery & Configuration
 - Adaptive Path Selection
 - Load Balancing

- Seamless Roaming

Security

- WPA-PSK, WPA2-PSK, WPA-EAP & WPA2-EAP
- WEP, TKIP & AES Encryption
- MAC Filtering
- SSID Hidden

Home Wi-Fi

- URL Filtering
- Time Restriction

- LED Control (ON/OFF, Schedule)
- Group Access Management

Protocols

- Management: HTTP,TR-069

Network

- Forward & Routing Traffic: Bridging/ routing/ Static routing
- DHCPv4/DHCPv6 (Server, Client)
- PPPoE Client
- VPN Passthrough (IPSEC, L2TP, ...)
- VLAN
- IPv4/IPv6 Dual Stack, IPv6 only
- NAT
- Port Forwarding
- DNS/DDNS

TECHNICAL SPECIFICATIONS

Interfaces

- WAN 1x 10/100 Base -T Ethernet Port (iGate EW12S)
- 1x 10/100/1000 Base -T Ethernet Port, PoE support (iGate EW12SG)

Management

- Local Management with WebGUI/CLI/Telnet
- Remote Management with Mobile App/Cloud (One Link/One Mesh)
- Device Information, Connection Statistic, Station monitoring
- Diagnostics Tool: Ping, Trace, Log
- Upgrade FW: Local, Remote
- Backup, Restore Configuration

Multi-WAN

- Wireless WAN connectivity (support Dual Band 2.4GHz & 5GHz)
- Ethernet WAN Connectivity
- WAN Connectivity using Repeater from available SSIDs

- LAN 1x 10/100/1000 Base -T Ethernet Port (iGate EW12SG)

Wi-Fi

- IEEE Standards 802.11 a/b/g/n/ac wave 2
- 802.11v

- PHY Rate 2.4GHz: 300Mbps
 5GHz: 867Mbps
 - Channel 2.4GHz: 20/40 MHz
 Bandwidth 5GHz: 20/40/80 MHz
 - Frequency 2.4 - 2.4835 GHz
 5.170 - 5.835 GHz
 - Radios Dual Radio
 2.4GHz: MIMO 2x2:2
 5GHz: MIMO 2x2:2
 - Antenna Internal Omni 2x2, 3dBi
 (2.4 GHz & 5 GHz)
 MU-MIMO, Beamforming
 - EIRP 23dBm (iGate EW12S)
 26dBm (iGate EW12SG)
 - SSID 4 SSIDs (2 SSIDs/radio)
 - CCU 40 Users/Radio
 - LED 1x Reset
 1x WPS
 1x Power/Ethernet/Wi-Fi
 LED
- Power**
- Types DC 12V-1A
 - Power 8W (MAX)
 Consumption
- Others**
- Operating 0°C ÷ 50°C
 temperature
 - Operating ≤95%
 humidity
 - Mounting Standing
 - Dimension 192x127x60 mm

LEDs and Buttons

- Buttons 1x Power

iGATE EW12S/SG MANAGEMENT SYSTEM – ONE TELCO PLATFORM

- Support management:
 - Different types of equipment
 - Different protocol: TR-069, SNMP, CAPWAP...
 - Devices of multiple services: Internet, IPTV, voice...
 - Compatible with iGate EW12S/SG to form a complete Indoor Mesh Access Point solution:
 - Web Service: One Mesh Cloud Controller
 - Management Protocol: TR-069
- Optimal investment costs:
 - CAPEX: Data Center, Server, etc.
 - OPEX: Operating, Maintenance, etc.
- Main Features:
 - Devices Management: list devices, Group devices
 - Configuration Management: Remote Config/Command, Firmware Update, Configuration Backup/Restore
 - Report Management: Collect, Analysis, Alarm
 - Performance Management: Collect, Performance Statistics
- Advantages:
 - “Zero Touch” - automatic device configuration

- Import Data Model via file
- Build Data Model via interactive information from the device
- Micro Service Architecture, easy to extend new protocol & devices
- Flexible Deployment: hosted or on premise
 - Easy Scalability
 - Distributed deployment
 - Deployment on Cloud, Virtualization
 - Vertical & Horizontal scaling
- Open interface via REST API, JSON
- Advanced feature: QoS/QoE
- Easy to customize and integrate according to customer requirements



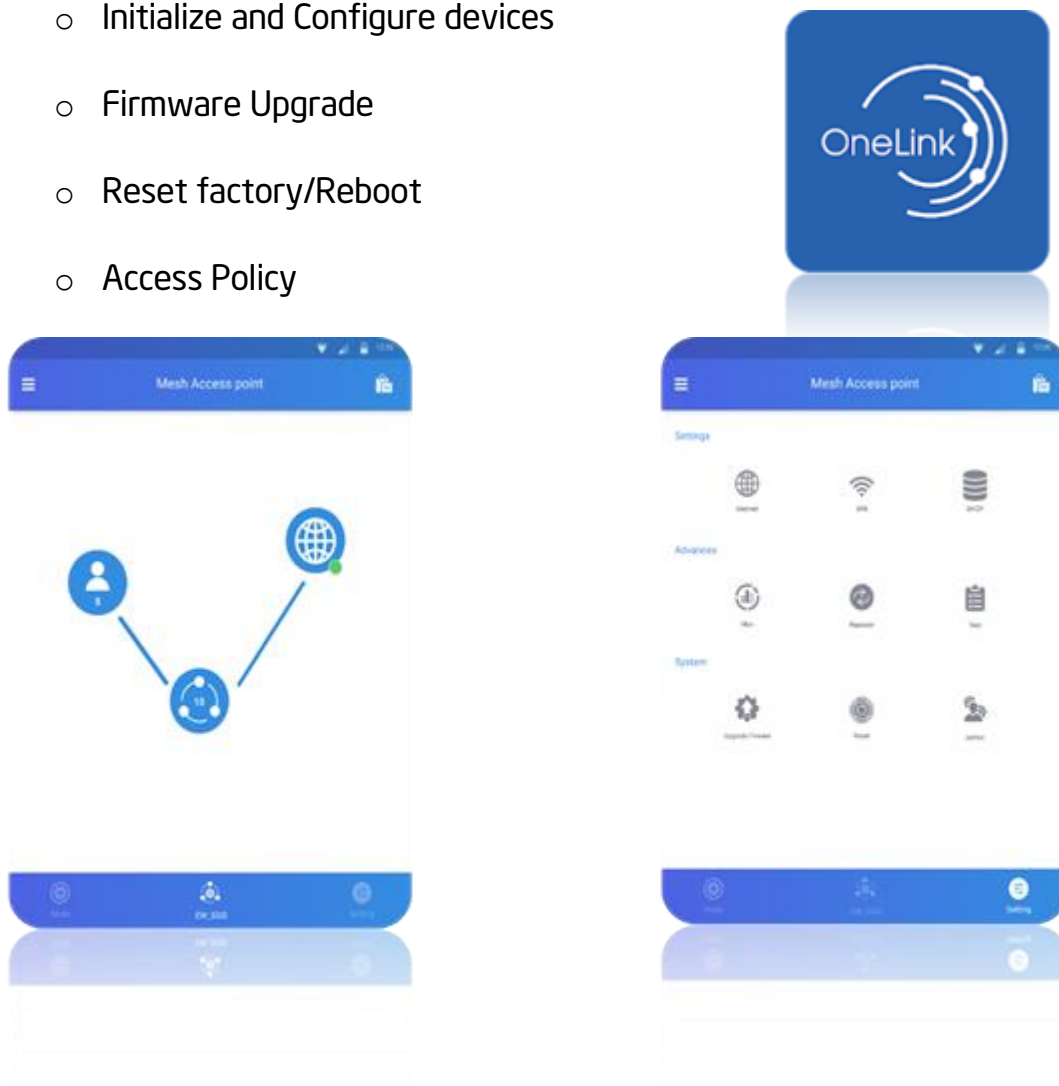

iGATE EW12S/SG MOBILE APP – ONE LINK

- Support Management:
 - Remote Management via internet (integrate with ONE Telco Platform)
 - Local Management via iGate EW12S/SG's Wi-Fi
- Main Features:
 - Automatically connect to the network and search for iGate EW12S/SG
 - Device Status Management, Network Quality, User Information
 - Initialize and Configure devices
 - Firmware Upgrade
 - Reset factory/Reboot
 - Access Policy



CUSTOMER CARE & TECHNICAL SUPPORT CENTRE

-  **Address:** 1st floor, VNPT Technology Building, No. 124, Hoang Quoc Viet Str., Cau Giay Dist., Hanoi, Vietnam
-  **Telephone:** +84.24.3750.6666 (24/7)
-  **Email:** support@vnpt-technology.vn